

National Infrastructure Planning
Temple Quay House
2 The Square
Bristol
BS16NP

Property Consultants

Unit 2, Paris, Parklands,
Railton Road, Guildford, GU2 9JX
T 01483 238389
E david.moody@brutonknowles.co.uk
W brutonknowles.co.uk
Offices across the UK

3rd March 2020

Dear Sirs,

Written response to questions raised by the Examining Authority on behalf of Mrs Agnes Patricia Engelen**Site: Court Close Farm, Portsmouth Road (A3), Cobham, Surrey KT11 1EN**

Further to my letter dated the 26th November, I have set out below further points raised by my client regarding the proposed temporary and permanent rights and acquisitions as a result of the proposed M25 JCT 10/A3 Wisley Interchange Improvement.

2.12.8 - Question to the Applicant, GGLW and the owner of Court Close Farm

Question a) Further to the meeting that took place between the Applicant, GGLW and the owner of Court Close Farm on 6 February 2020 to discuss an 'alternative solution' for access to the Heyswood campsite and Court Close Farm [paragraph 2.2.1 of REP4-010], please provide an update on how discussions have progressed since the 6 February meeting.

On the 6th February 2020, Highways England and their representatives met with my clients' Mrs Pat Engelen, and the Girl Guides, to discuss an alternative route for the Private Means of Access (PMA), which would avoid dissecting the Girl Guides site at Heyswood Campsite, and alleviate some of the significant safeguarding concerns raised previously. It was noted however, that elements of their proposal would require private agreements to be in place requiring use of land (permanently) that is outside of the currently proposed development boundary, and which would be required to facilitate the inclusion of passing bays or minor widening of the working area.

The idea was generally considered an improvement to the plan currently submitted for consideration, and both The Girl Guides & Mrs Engelen were more positive in support of the alternative options being discussed. The preference was for the option to include passing bays as opposed to the traffic light solution.

There was however a matter raised, which my client needs to have clarified as a matter of urgency regarding the way in which Highways England is expecting the new road to be maintained. I understand that this will be a PMA and that by virtue of providing it, Highways England and Surrey County Council Highways will not be responsible for its future maintenance, which will lie with its users.

Whilst the principle remains quite straight forward, I noted that the Highways England's representatives in attendance referred to this affecting the entire length of the new road back to the Painshill/A3 slip road junction. I have asked for confirmation of where I can find Highways England's proposal in regard to the future maintenance responsibility of the PMA.



Authorised and regulated by the Financial Conduct Authority

Bruton Knowles LLP is a limited liability partnership registered in England and Wales with registered number OC418768
Registered Office Olympus House, Olympus Park, Quedgeley, Gloucester GL2 4NF.



INVESTOR IN PEOPLE



A list of Partners is available upon request

This would burden my client with a responsibility to maintain in part or contribute to the maintenance of a new road, which will be around 1km in length. I believe Highways England will own the proposed PMA upon completion of the proposed works and retain access over the road for access to its gantries.

My client currently enjoys access directly off the A3, and therefore has very little maintenance liability outside of her property boundaries. If this is not to be replicated as part of the scheme, which I feel should be Highways England's criteria in implementing its replacement, I have requested details of what consideration has been assessed in my clients favour to offset any subsequent costs and liabilities.

Subsequently, the following additional enquiries have been made by Highways England:

1. Whether my client (Mrs Engelen) would consider a freehold sale of her title in full
2. A follow up meeting on the 24th February 2020, to update her on the alternative access proposals

The follow up meeting was to discuss a variation to their alternatives proposed during the 6th February meeting. Essentially, the proposal remained the same, though an additional 3m width would need to be acquired temporarily, through the Girl Guides site, currently outside of the DCO boundary. It was also noted that Highways England did not think their alternative proposal would get approval.

- Please see plans attached: HE551522-ATK-HGN-A3-L2-R13__OP-SK-CH-000006 Rev C02 & 000010 Rev C01

To date, we have not received copies of the meeting minutes from the 6th or 24th of February site meetings.

This has only raised further concerns about how and what Highways England are intending to deliver and under what means. Safeguarding for the Girl Guides site remains of paramount importance. The alternative alignment appears in principle to offer a far more palatable solution to the current plans with the Examining Authority for consideration, though my client awaits Highways England's meeting notes from the 6th & 24th February 2020 to be in a position to comment further.

Yours sincerely

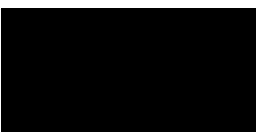

David Moody MInstRE
Associate

By email: M25Junction10@planninginspectorate.gov.uk

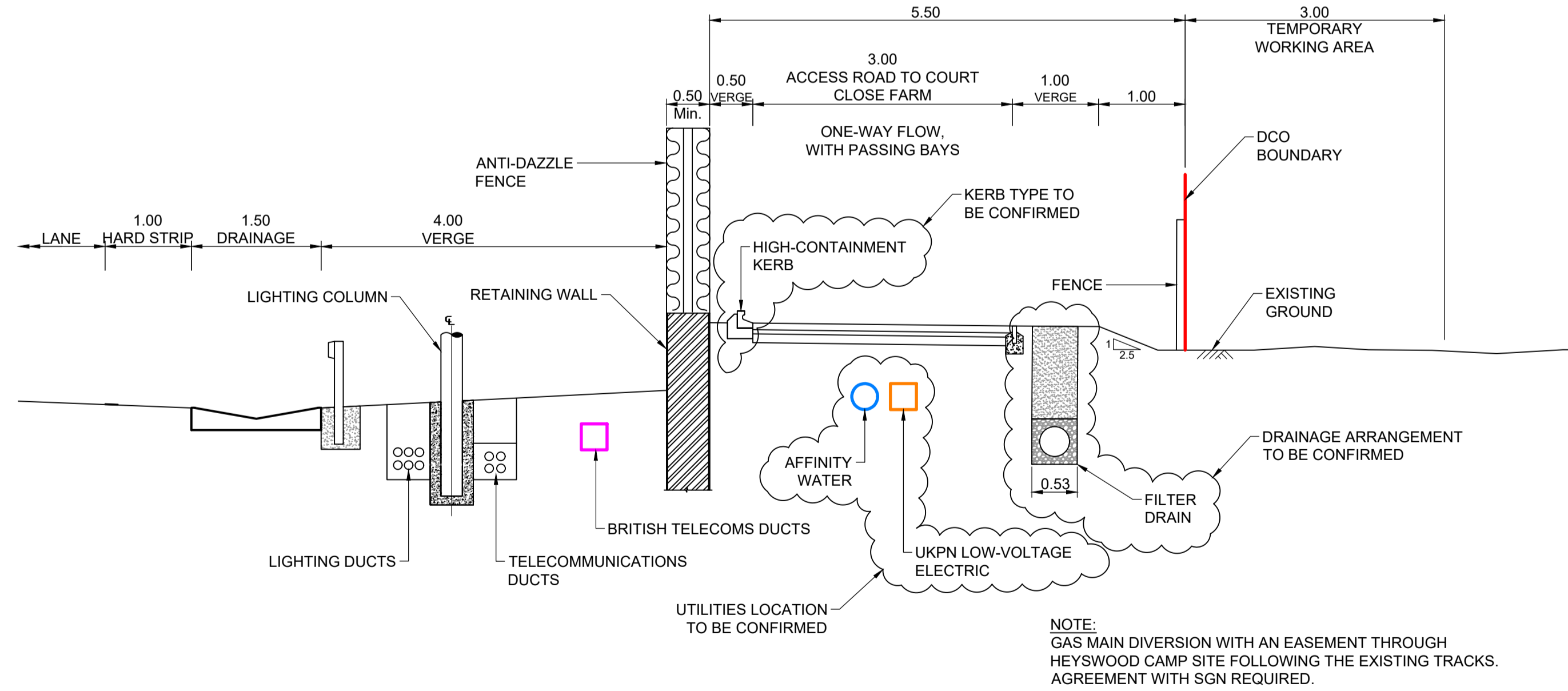
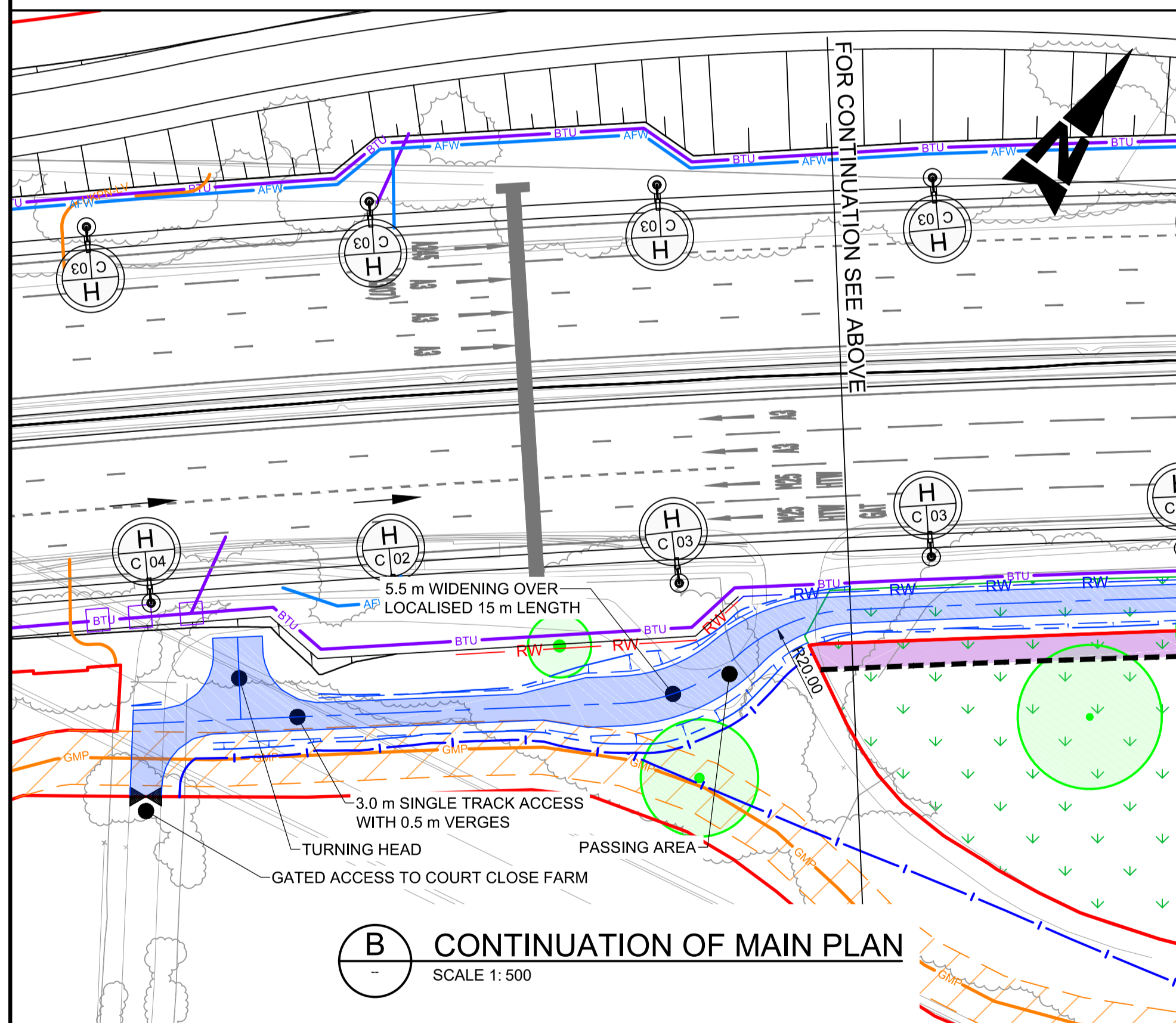
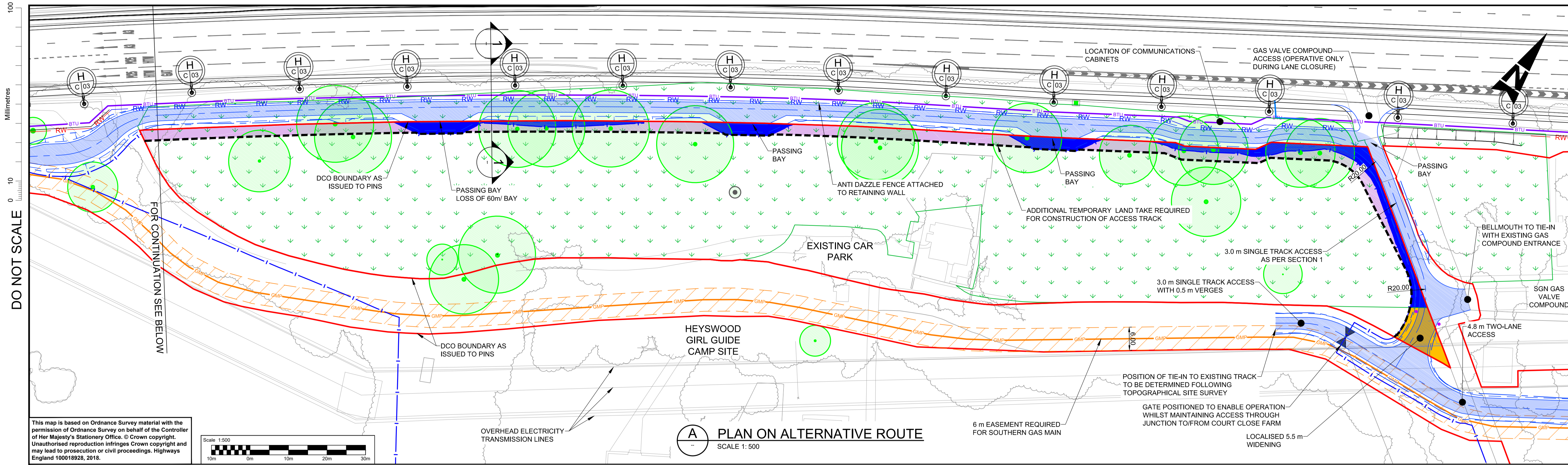

- OPTION POSITIVES**
- NO ACCESS TRACK FOR COURT CLOSE FARM THROUGH HEYSWOOD SITE
 - HEYSWOOD MAIN SITE AND ANCIENT WOODLAND REMAIN CONTIGUOUS
- OPTION NEGATIVES**
- LOSS OF ANCIENT WOODLAND WITHIN HEYSWOOD CAMP SITE = 1115m²
 - LOSS OF OTHER LAND WITHIN HEYSWOOD CAMP SITE = 103m²
 - TOTAL PERMANENT AND TEMPORARY LAND TAKE FROM HEYSWOOD CAMP SITE, OUTSIDE OF DCO BOUNDARY = 1218m²
 - SINGLE TRACK, ONE-WAY, WITH PASSING BAYS TO COURT CLOSE FARM
 - SGN EASEMENT REQUIRED THROUGH HEYSWOOD SITE

- NOTES:**
1. ALL DIMENSIONS ARE IN METRES UNLESS OTHERWISE STATED.
 2. THE DESIGN IS SUBJECT TO DEVELOPMENT AND MAY CHANGE AS DETAIL DEVELOPS.
 3. ONLY SELECTED UTILITIES ARE SHOWN, FOR CLARITY.

- LEGEND:**
- EXISTING SIGNIFICANT TREES
 - ANCIENT WOODLAND
 - PERMANENT LOSS OF ANCIENT WOODLAND WITHIN HEYSWOOD CAMP SITE = 410m²
 - PERMANENT LOSS OF OTHER LAND WITHIN HEYSWOOD CAMP SITE = 103m²
 - GATED ACCESS
 - BOUNDARY OF ALTERNATIVE OPTION
 - TEMPORARY USE OF LAND FOR CONSTRUCTION WORKING AREA AND PERMANENT LOSS OF ANCIENT WOODLAND WITHIN HEYSWOOD CAMP SITE = 705m²

SAFETY, HEALTH AND ENVIRONMENTAL INFORMATION

In addition to the hazards/risks normally associated with the types of work detailed on this drawing, note the following significant residual risks (Reference shall also be made to the design hazard log).

Description	Status	Revision	Drawn	Checked	Reviewed	Authorised	Issue Date
Construction	NONE						
Maintenance / Cleaning	NONE						
Use	NONE						
Decommissioning / Demolition	NONE						

Description	Status	Revision	Drawn	Checked	Reviewed	Authorised	Issue Date
Construction	NONE						
Maintenance / Cleaning	NONE						
Use	NONE						
Decommissioning / Demolition	NONE						

Drawing Suitability: APPROVED - PUBLISHED
Status: A1
Project Title: M25 junction 10/A3 Wisley interchange

ATKINS
Epsom Gateway
Ashley Avenue
Epsom
Surrey
KT18 5AL
Tel: +44 (0)1372 726140
Fax: +44 (0)1372 740055
www.atkinsglobal.com

Copyright © Atkins Limited (2018)

Client: Working on behalf of **highways england**

Description	Status	Revision	Drawn	Checked	Reviewed	Authorised	Issue Date
Construction	NONE						
Maintenance / Cleaning	NONE						
Use	NONE						
Decommissioning / Demolition	NONE						

Drawing Title: HEYSWOOD GIRL GUIDE CAMP ALTERNATIVE ACCESS OPTION 2 GGLW PREFERRED ROUTE SINGLE TRACK WITH PASSING BAYS

Drawing Number: HE551522 - ATK - HGN -
Project: A3_L2_R13_OP - SK - CH - 000010
Location: Type: Role: Number: Rev: C01

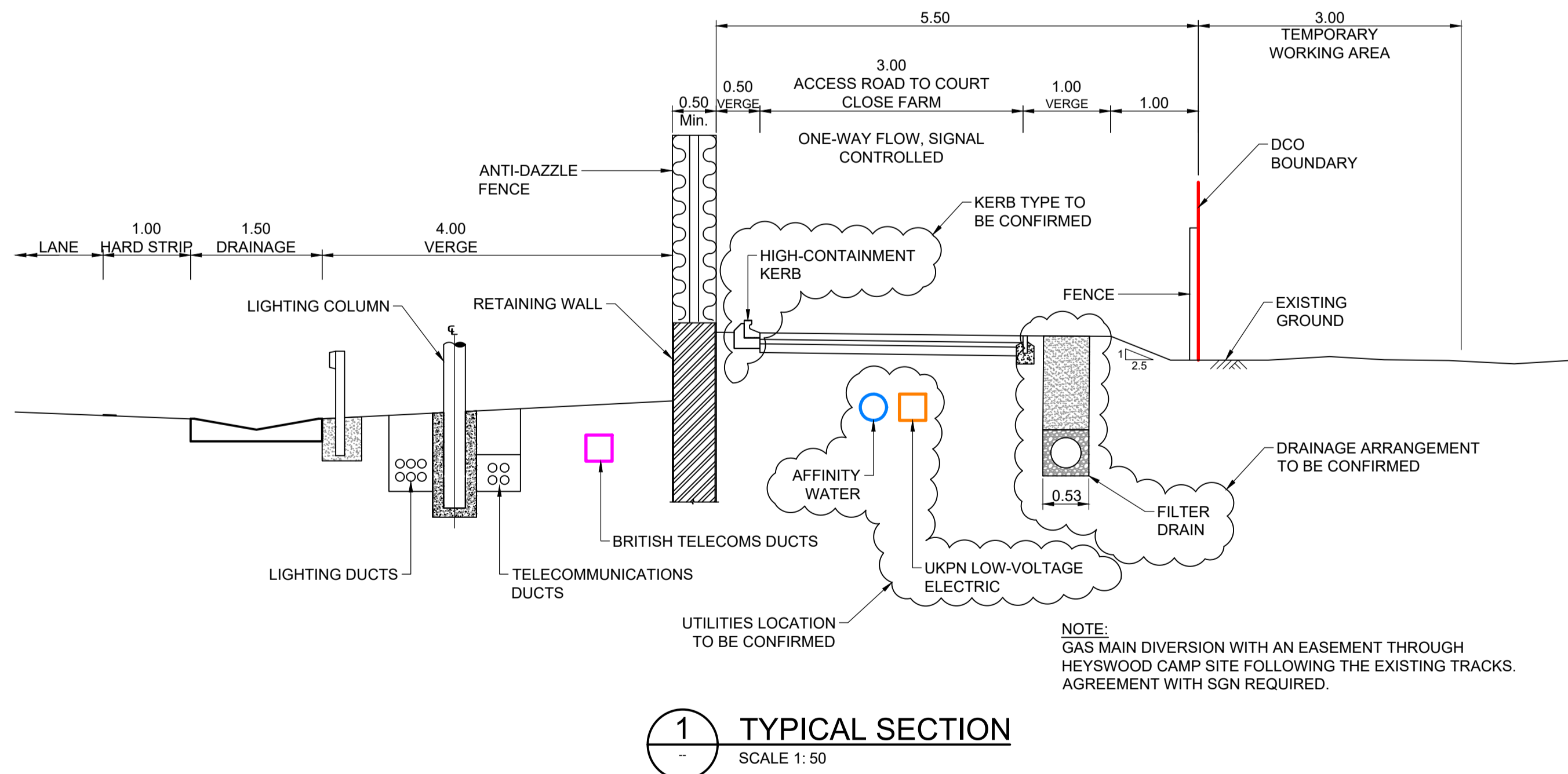
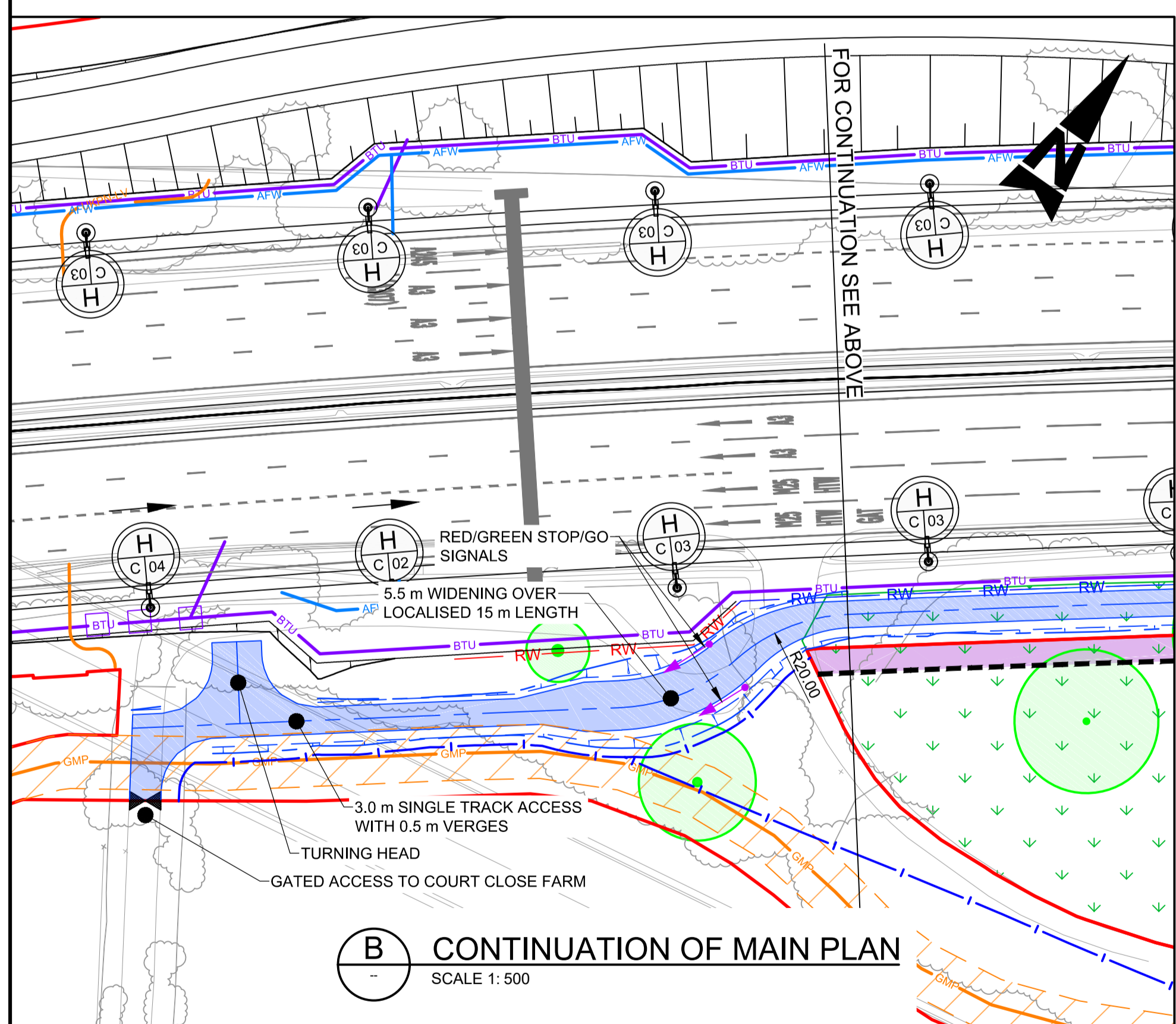
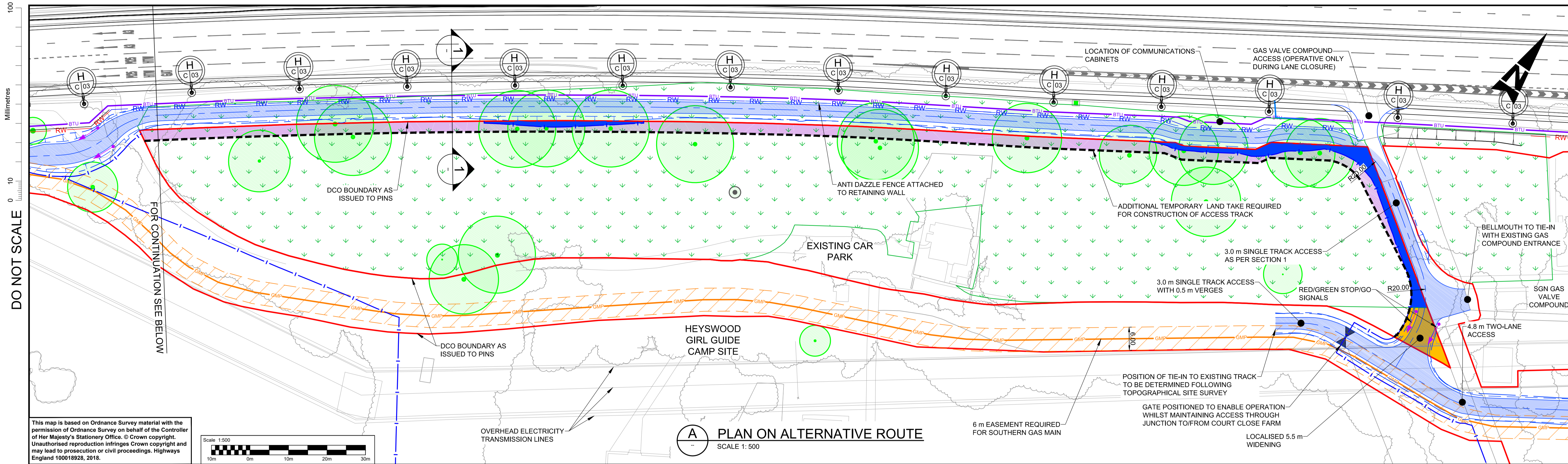

- OPTION POSITIVES**
- NO ACCESS TRACK FOR COURT CLOSE FARM THROUGH HEYSWOOD SITE
 - HEYSWOOD MAIN SITE AND ANCIENT WOODLAND REMAIN CONTIGUOUS
- OPTION NEGATIVES**
- LOSS OF ANCIENT WOODLAND WITHIN HEYSWOOD CAMP SITE = 1102m²
 - LOSS OF OTHER LAND WITHIN HEYSWOOD CAMP SITE = 103m²
 - TOTAL PERMANENT AND TEMPORARY LAND TAKE FROM HEYSWOOD CAMP SITE, OUTSIDE OF DCO BOUNDARY = 1205m²
 - SINGLE TRACK, ONE-WAY, SIGNAL CONTROLLED ACCESS TO COURT CLOSE FARM
 - SGN EASEMENT REQUIRED THROUGH HEYSWOOD SITE

- NOTES:**
1. ALL DIMENSIONS ARE IN METRES UNLESS OTHERWISE STATED.
 2. THE DESIGN IS SUBJECT TO DEVELOPMENT AND MAY CHANGE AS DETAIL DEVELOPS.
 3. ONLY SELECTED UTILITIES ARE SHOWN, FOR CLARITY.

- LEGEND:**
- EXISTING SIGNIFICANT TREES
 - ANCIENT WOODLAND
 - PERMANENT LOSS OF ANCIENT WOODLAND WITHIN HEYSWOOD CAMP SITE = 240m²
 - PERMANENT LOSS OF OTHER LAND WITHIN HEYSWOOD CAMP SITE = 103m²
 - GATED ACCESS
 - RED/GREEN STOP/GO SIGNAL
 - BOUNDARY OF ALTERNATIVE OPTION
 - TEMPORARY USE OF LAND FOR CONSTRUCTION WORKING AREA AND PERMANENT LOSS OF ANCIENT WOODLAND WITHIN HEYSWOOD CAMP SITE = 862m²

SAFETY, HEALTH AND ENVIRONMENTAL INFORMATION

In addition to the hazards/risks normally associated with the types of work detailed on this drawing, note the following significant residual risks (Reference shall also be made to the design hazard log).

Description	Status	Revision	Drawn	Checked	Reviewed	Authorised	Issue Date
Construction	NONE						
Maintenance / Cleaning	NONE						
Use	NONE						
Decommissioning / Demolition	NONE						

Description	Status	Revision	Drawn	Checked	Reviewed	Authorised	Issue Date
DESCRIPTION SUBMITTED FOR DEADLINE 4	A1	CO1	SB	LH	RM	GB	11/02/20
DESCRIPTION SUBMITTED FOR DEADLINE 5	A1	CO2	SB	LH	RM	RB	27/02/20

Drawing Suitability: APPROVED - PUBLISHED | Status: A1 | Project Title: M25 junction 10/A3 Wisley interchange

ATKINS Epsom Gateway, Ashley Avenue, Epsom, Surrey, KT18 5AL. Tel: +44 (0)1372 726140, Fax: +44 (0)1372 740055, www.atkinsglobal.com

highways england

Client: Working on behalf of highways england

Drawing Number: HE551522 - ATK - HGN - A3_L2_R13_OP - SK - CH - 000006 | Originator: | Volume: | Location: | Type: | Role: | Number: | Original Size: A1 | Scale: AS SHOWN | Project Ref. No.: 5158141 | Sheet: 1 of 1 | Rev: C02